

IOT SMART HOME IP VIDEO PHONE

KCV-S701IP NEW

- 7" Color digital LCD monitor
- Easy to operate using OSD menu and icon button
- Receive call & door open from Smartphone
- Door camera monitoring from Smartphone
- Security sensors adaptable



COLOR



BLACK



WHITE

SPECIFICATIONS

Model	KCV-S701IP
Display	7" Digital LCD
Power Source	AC100V ~ 240V, 50Hz/60Hz
Power Consumption	4.5W(Standby), 15W(Max)
Mount Type	Surface mount
Operating Temperature	0°C ~ +40°C
Dimension	197(W) x 176(H) x 23(D) mm

WIRING DIAGRAM

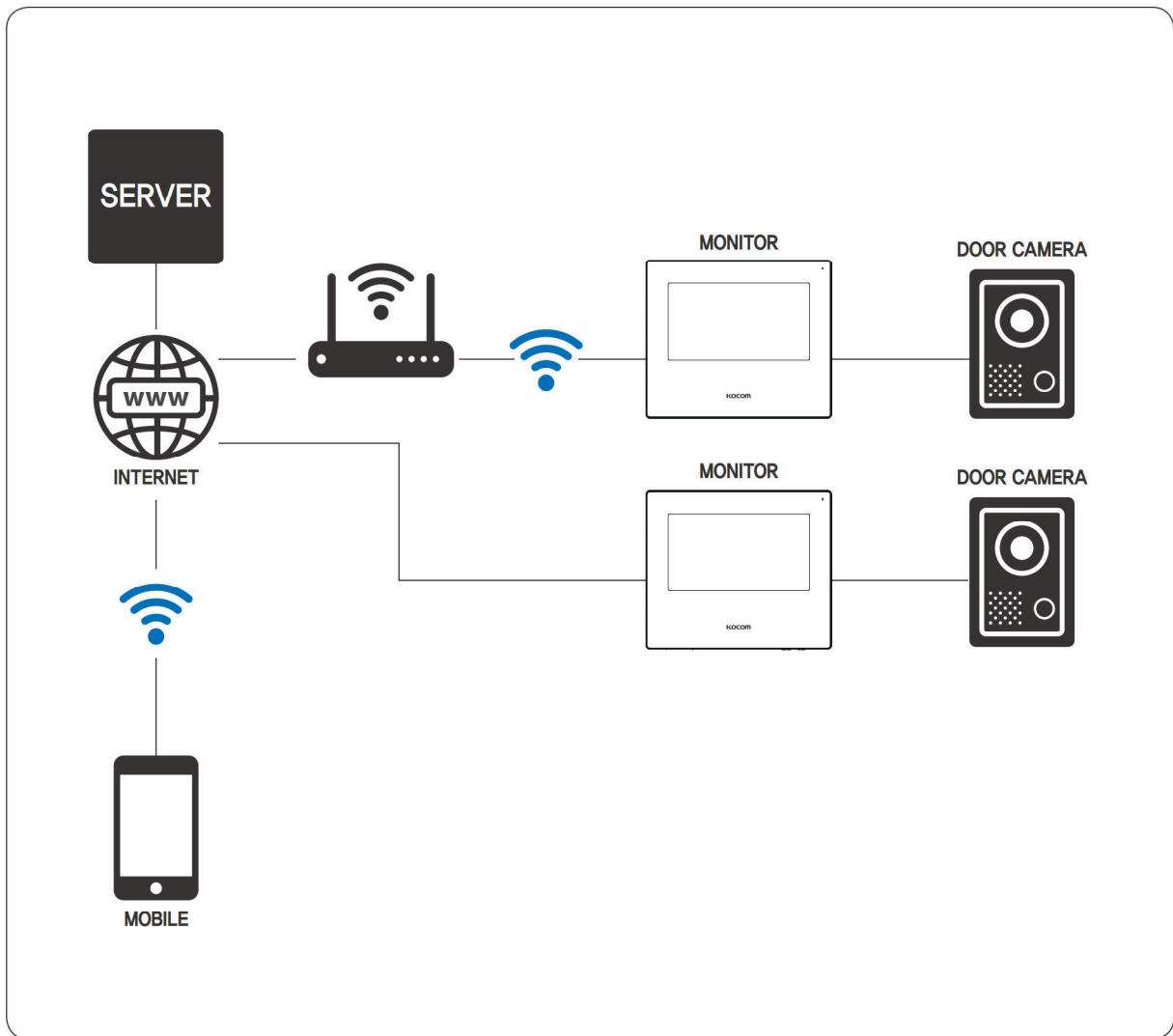

DOOR CAMERA
KC-S81M NEW



SPECIFICATIONS

Power	DC 11V±1V(power from monitor)
Power Consumption	Max. 3W
Wiring	4 Wire
Body Material	Metal
Mount Type	Surface mount
Camera Angle	100 ° (Angle Abjustable)
Min. Illumination	0.1 lux(LED ON)
Dimesion	70(W) x 125(H) x 21(D)mm

WIRING

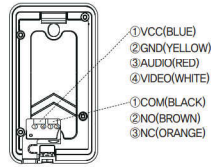

DOOR CAMERA
KC-94 NEW



SPECIFICATIONS

Power	DC 12V±1V(power from monitor)
Power Consumption	Max. 2,5W
Wiring	4 Wire
Body Material	Plastic
Mount Type	Flush mount
Camera Angle	100 ° (Angle Abjustable)
Min. Illumination	0.1 lux(LED ON)
Dimesion	89(W) x 131(H) x 13(D)mm

WIRING

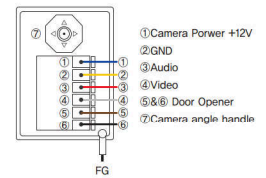

DOOR CAMERA
KC-MC30

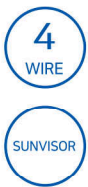

SPECIFICATIONS

Power	DC 12V±1V(power from monitor)
Power Consumption	Max. 2,5W
Wiring	4 Wire
Body Material	Metal
Mount Type	Surface mount
Camera Angle	100 ° (Angle Abjustable)
Min. Illumination	0.1 lux(LED ON)
Dimesion	110(W) x 158(H) x 39(D)mm

WIRING

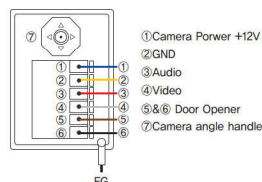

DOOR CAMERA
KC-C60



SPECIFICATIONS

Power	DC 12V±1V(power from monitor)
Power Consumption	Max. 2,5W
Wiring	4 Wire
Body Material	Plastic
Mount Type	Surface mount
Camera Angle	100 ° (Fixed)
Min. Illumination	0.1 lux(LED ON)
Dimesion	95(W) x 12(H) x 34(D)mm

WIRING

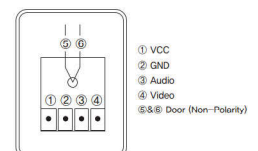







Making your home more **convenient** and **safer**

KOCOM SMART HOME IP VIDEOPHONE **KCV-S701P**



**A BREATH OF FRESH AIR IN YOUR HOME
KOCOM SMART IP VIDEO DOORPHONE**

KOCOM provides you with the best comfort of your daily life.
It is easy to install and enables visitor's identification through your smart phones.

-  Video and audio monitoring of the camera(s)
-  7" Color digital LCD monitor
-  Receive instant notifications to your smart phone through WiFi & Ethernet in local and remote places
-  Operating condition display with icons (OSD)
-  Call & Communication with visitors
-  Door opening function

DISTRIBUTED BY:
B G W
TECHNOLOGIES

ANDROID APP ON
Google play

Available on the
App Store

Smartphone APP download



Android



i-OS

It's a state of art technology that provides installers with options either wifi or ethernet.
Not only comfort, also serucity is ensured as it enables communication with visitors through smart phone in any place even you are not at home.

Making your home more convenient and safer

APP DOWNLOAD, SPECIFICATION OF SMART PHONE AND NETWORK

Item	Description
Recommended spec of smart phone	Android 6.0 version or higher iOS 11.4 version or higher Bluetooth 4.1 standard (Range: Within 1m)
Recommended spec of wireless router	Wireless router using only 2.4G -wireless router using 2.4G and 5G may not interwork -IEEE 802.11 b/g/n
Recommended network delay time	KCV-S701IP ↔ AP within 50msec KCV-S701IP ↔ CLOUD within 100msec -In case that delay time of network exceeds the aforementioned, it may not interwork Depending upon the status of 3G, LTE and telecom
Recommended Network data rates	20Mbps Depending on network transmission speed and condition, the video or voice would be disconnected

WIRING DIAGRAM

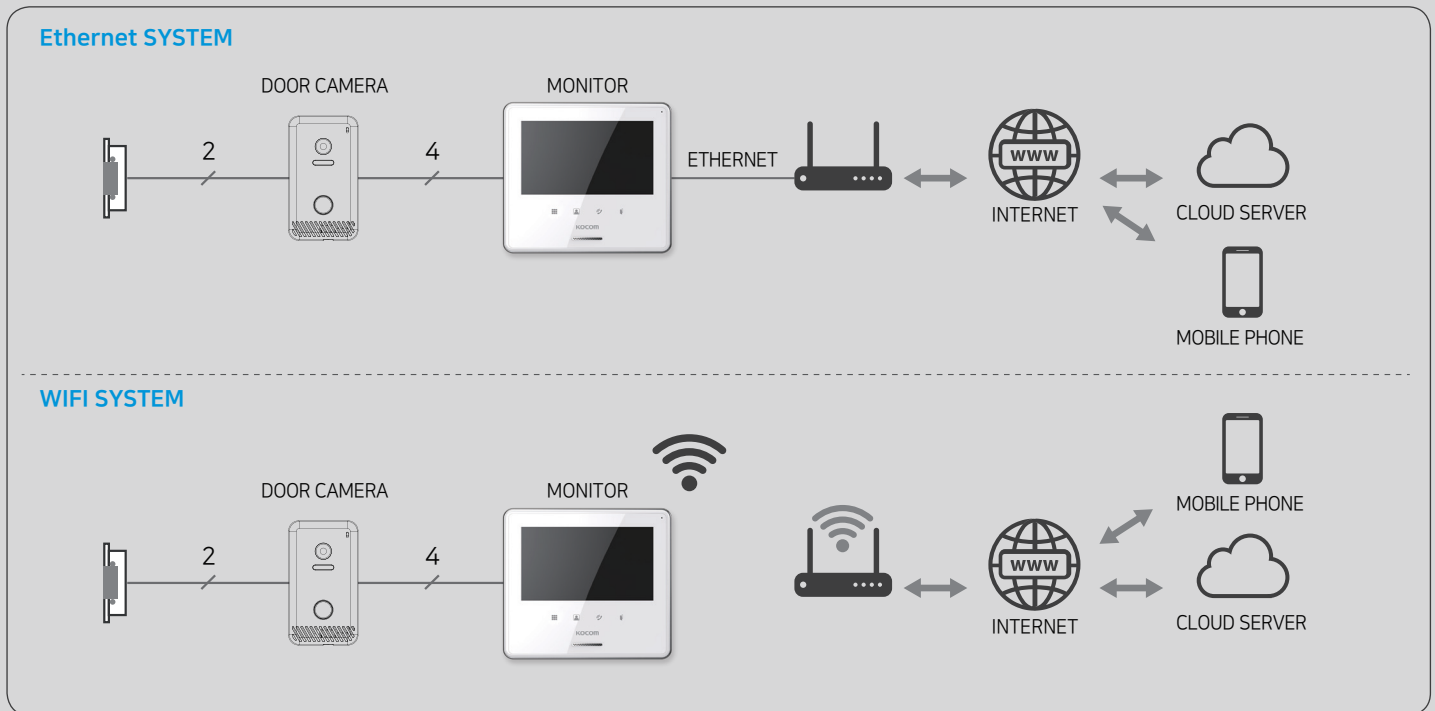

PRODUCT DIMENSION

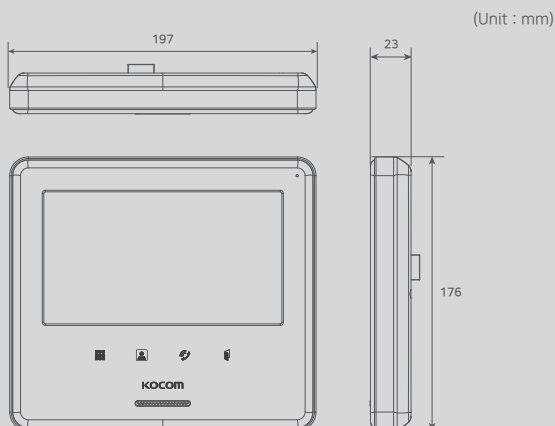

ACCESSORY



HOW TO CONNECT

To bring this unit into the system in a proper way with your mobile phone, please follow below structure in numerical order

1



To set WIFI mode of wireless AP at KCV-S701IP, you must install APP called "KOCOM SMART HOME" to your Android Phone / iPhone.
Please scan APP QR code on page 1 of this leaflet.
Or you can download by following below steps
- Android : Google playstore > KOCOM smarthome
- i-OS : Appstore > KOCOM smarthome

2

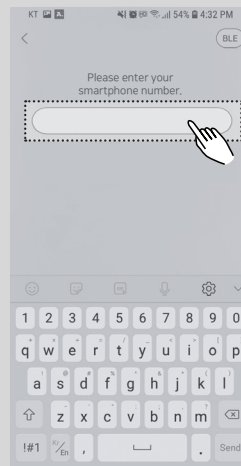

Enter your phone number.
REMARK: (For Ethernet connection, the app won't request you to put your mobile number)

3



Enter your wifi information and password.
REMARK: (For Ethernet connection, the app won't request you to put your mobile number)

4



Press the menu button button.

5

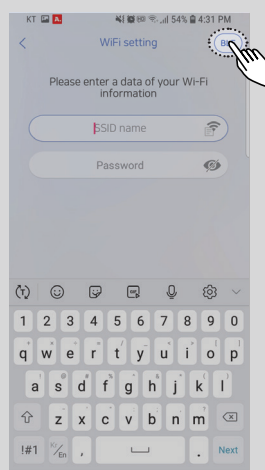

Click "BLE" button for WIFI setup and the unit will show an icon that show you WIFI is connected.

6

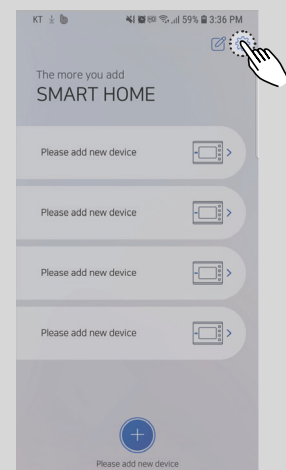

Press Add new device. Then, it'll require PIN number and you can find from the videophone. Then, installation complete.

Using the
APP



EASY MONITORING

Able to use KOCOM app to easily find your visitor, even you are out of home.



SMART OPEN

You can open the door through your mobile, no need to run toward your monitor while you are in bed, bathroom, or outside of home.



KOCOM SMART HOME APP

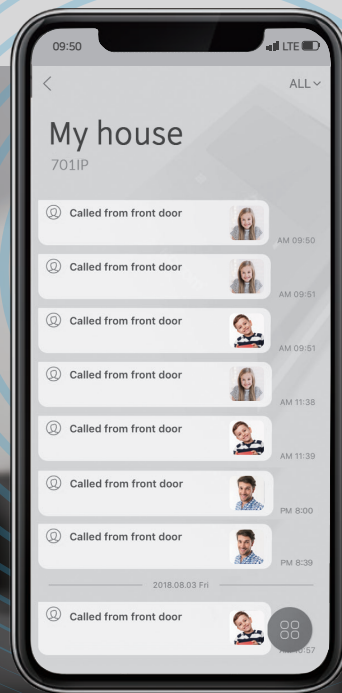

Model No.	KCV-S701IP
Power Source	DC 12V-1A Adaptor
Power Consumption	3.5W(±20%)(Stand by), 9W(±20%)(In load)
Operating Temperature	0°C ~ +40°C
LCD	7" color LCD
Communication System	Handsfree Type
Ethernet interface	10/100 BASE-T
WIFI	802.11 b/g/n
Bluetooth 4.1	Bluetooth 4.1
Wiring	Door camera : Polarized 4 wire LAN : UTP(cat.5e or Higher)
Mount Type	Surface mount
Dimension	220(W) x 123(H) x 19(D) mm