

## Federal Communications Commission Statement

This equipment has been tested and found to comply with the limits for a Class B digital device, pursuant to Part 15 of the FCC Rules. These limits are designed to provide reasonable protection against harmful interference in a residential installation. This equipment generates, uses, and can radiate radio frequency energy and, if not installed and used in accordance with the instruction, may cause harmful interference to radio communications. However, there is no guarantee that interference will not occur in a particular installation. If this equipment does cause harmful interference to radio or television reception, which can be determined by turning the equipment off and on, the user is encouraged to try and correct the interference by one of the following measures:

Reorient or relocate the receiving antenna,

Increase the separation between the equipment and receiver,

Connect the equipment into an outlet on a circuit different from that to which the receiver is connected.

Consult the dealer or an experienced radio/TV technician for help.

This device complies with Part 15 of the FCC Rules. Operation is subject to the following two conditions: (1) this device may not cause harmful interference, and (2) this device must accept any interference received, including interference that may cause undesired operation.

FCC Caution: Any changes or modifications not expressly approved by the party responsible for compliance could void the user's authority to operate this equipment.

## Limited Warranty

Vision Guarantees that every wireless siren & strobe alarm is free from physical defects in material and workmanship under normal usage for one year from the date of purchase. If the product proves defective during this one-year warranty period, Vision will replace it free of charge. Vision does not issue any refunds. This warranty is extended to the original end user purchase only and is not transferable. This warranty does not apply to : (1) damage to units caused by accident, dropping or abuse in handling, or any negligent usage; (2) units which have been repaired, taken apart, or modified by an unauthorized personnel; (3) units not used in accordance with instruction; (4) damages exceeding the cost of the product; (5) transit damage, initial installation costs, removal cost, or reinstallation cost.

For information on additional devices, please visit us at [www.visionsecurity.com.tw](http://www.visionsecurity.com.tw)



## Installation & Operation Manual

**ZM 1602 US**

**ZM 1602 EU**

**ZM 1602 BR**

**ZM 1602 JP**

## DC/AC Power Siren

ZM 1602	V2	1010201	6B1Z-16003
---------	----	---------	------------

## Introduction

Thanks for choosing the Vision's wireless siren & strobe alarm of the home security device. This sensor is a Z-Wave™ enabled device (interoperable, two-way RF mesh networking technology) and is fully compatible with any Z-Wave™ enabled network. Every main powered Z-Wave™ enabled device acts as a signal repeater and multiple devices result in more possible transmission routes which helps eliminate "RF dead-spots". Z-Wave™ enabled devices displaying the Z-Wave™ logo can also be used with it regardless of the manufacturer, and ours can also be used in other manufacturer's Z-Wave™ enabled networks. This product will sound a loud siren and flash a strobe light when an alarm message or alert is received on any Z-Wave™ enabled network. When ZM 1602 main power has dropped out, the backup batteries will automatically install.

## Product Description and Specification

\*\*\* For indoor use only \*\*\*

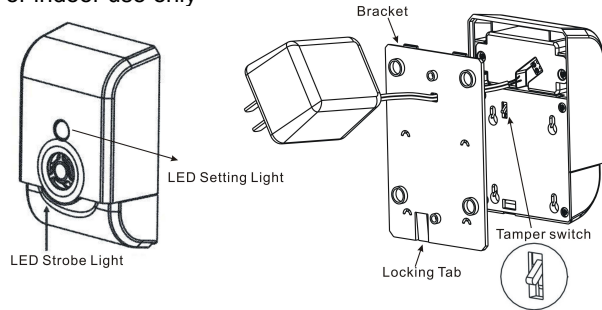

### Specification:

Protocol: Z-Wave™ (ZM3102N/ZM4102AH)

Frequency Range:

868.42MHz (ZM1602EU)

908.42MHz (ZM1602US)

921.42MHz (ZM1602BR)

920-928MHz (ZM1602JP)

Operating Range: Up to 100 feet line of sight

Loud Audible Alarm: > 105dB@1meter

LED Strobe Lighting

Operating Temp.: -15°C~ 60°C (5°F~140°F)

### Z-Wave Command Class:

COMMAND\_CLASS\_BASIC

COMMAND\_CLASS\_CONFIGURATION

COMMAND\_CLASS\_MANUFACTURER\_SPECIFIC

COMMAND\_CLASS\_SWITCH\_BINARY

COMMAND\_CLASS\_VERSION

Note: COMMAND\_CLASS\_BASIC Mapping COMMAND\_CLASS\_SWITCH\_BINARY

### Package Content:

1pc ZM 1602 Siren

1pc Adhesive tape

2pcs Screw

1pc Installation & Operation Manual

Note: Power adapter excluded

## Installation

Notice: If you are installing the entire Z-Wave™ system for the first time, please refer to the installation guide of Z-Wave™ Interface Controller before installing ZM1602.

1. Remove the bracket from the siren by press the locking tab, and then gently slide up the siren.
2. Remove two screws and pull out the plastic case as below. Pull out the short head & put back into the position where two pin heads are covered.

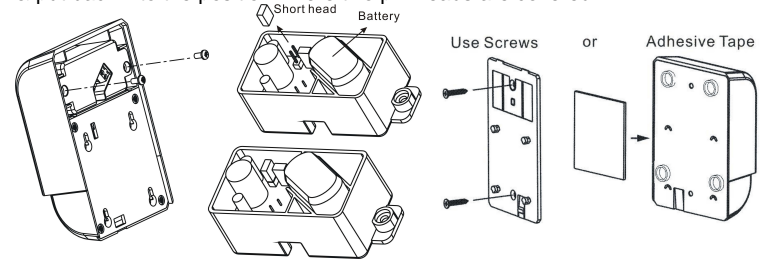

3. Knock out the thin wall on the bracket. Power line goes through the hole on bracket and connects to screw terminal on ZM1602.
4. Using the screws or adhesive tape to affix the bracket on the chosen location.
5. Slide back the cover and screw fastening with the front cover.

For "Inclusion" in (adding to) a network: Put the Z-Wave™ Interface Controller into "inclusion" mode, and following its instruction to add the ZM 1602 to your controller. To get in the "inclusion" mode, the distance between siren and controller is suggested to be in one meter. Open the bracket and press the tamper switch of ZM 1602 for 1 second at least & release to be included. After setting, the LED Setting Lighting should go off, if not, please try again.

For "Exclusion" from (removing from) a network: Set up the Z-Wave™ Interface Controller into "exclusion" mode, and following its instruction to delete the ZM 1602 from your controller. Press the tamper switch of ZM 1602 for 1 second at least & release to be excluded.

- Please note:
1. LED setting light will flash continuously in Exclusion condition.
  2. ZM 1602 can only connect to DC 12~39V, AC 9~28V Power adapter
  3. ZM 1602 is extremely LOUD, please don't near your ear when you test!

7. Configuration Command Class:  
Parameter 0: Siren/ Strobe Mode, 1 Byte Value: 0=siren and Strobe enable (default), 1=siren only, 2= Strobe only.  
Parameter 1: Alarm auto stop time command, 0=30 seconds (default), 1= 60 secs, 2= 120 secs, 3= siren will not automatically stop.

## Operation

1. Normal operation, the LED light will not on.
2. Alarm mode (It is status of alarm triggered): It is based on the user's configuration setting of LED flash ON/OFF and Siren ON/OFF. ZM 1602 will sound a loud, when Basic set/Binary Switch On signal is received
3. Self-Protection Mode: After put back the bracket over 5 seconds, ZM 1602 will enter Self-Protection mode. If the back cover is opened will triggered the Self-Protection mode. The alarm time is default 30 seconds.